

News 02-2010

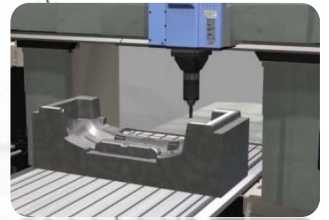

O.M.G.

The **Big**Technology for the **Big**Industry



Military Industries

Cars Industries

Aerospace Industries

Energy Industries

Mold & Die Industries

accessories for the **Big**MachinesTools



Made in Italy

Sistemi di foratura
Sistemi di foratura
Sistemi di foratura

Accessories for the **BigMachinesTools**



Angle head **TAS07408**

- Power up to 35 Kw
- Torque 600 Nm
- Ratio I-O: 1-2
- Max RPM 3.000
- ATC output BT50, DIN69871-A50, DIN69893-HSK100, CAPTO C8
- Manual C axis rotation
- Coolant through the tool centre
- Weight Kg 265

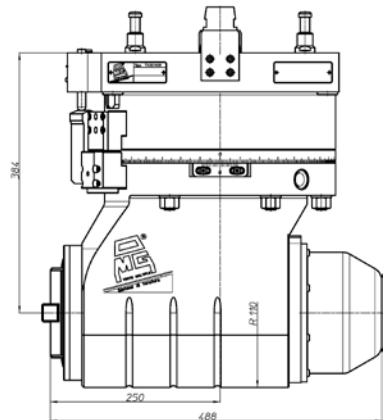

Angle head **TAS33108**

- Power up to 35 Kw
- Torque 850 Nm
- Ratio I-O: 1-2
- Max RPM 4.000
- ATC output BT50, DIN69871-A50, DIN69893-HSK100, CAPTO C8
- Automatic C axis rotation: step 1° or 2,5°
- Coolant through the tool centre
- Weight Kg 400

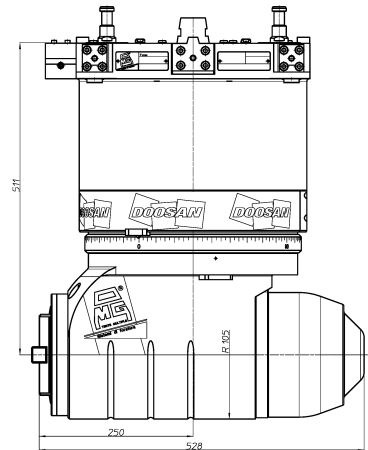

Extension head **TFS33708**

- Power up to 45 Kw
- Same torque of machine spindle
- Ratio I-O: 1-1
- Max RPM 6.000
- ATC output BT50, DIN69871-A50, DIN69893-HSK100, CAPTO C8. Cooling spindle
- Coolant through the tool centre
- Weight Kg 225

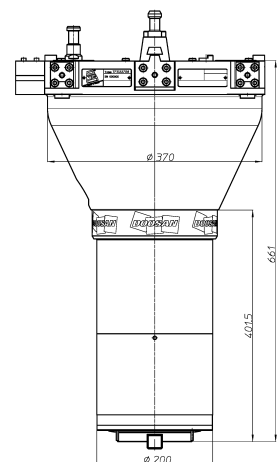

The **Big**Technology for the **Big**Industry



Twin Spindle Angle head **TAS28307**

- Power up to 40 Kw
- Torque 750 Nm
- Ratio I-O: 1-1
- Max RPM 2.000
- Double output BT50, DIN69871-A50, DIN69893-HSK100. Manual tool change
- C axis, manual rotation by worm gear
- Weight Kg 560

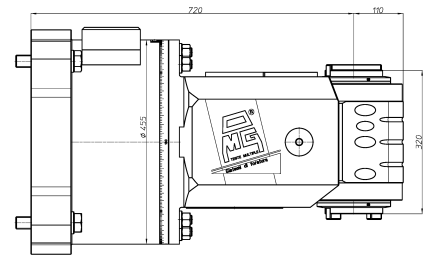

Tilting Angle Head **TAV19009**

- Power up to 60 Kw
- Torque 1.800 Nm
- A axis: $\pm 120^\circ$. C axis: $\pm 185^\circ$
- A and C axis rotation: by worm gear and axis motor. Clamping axis by brake
- Ratio I-O: 1-1
- Max RPM 2.500
- ATC output: BT50, DIN69871-A50, DIN69893-HSK100, CAPTO C8
- Coolant through the tool centre
- Weight Kg 1.800

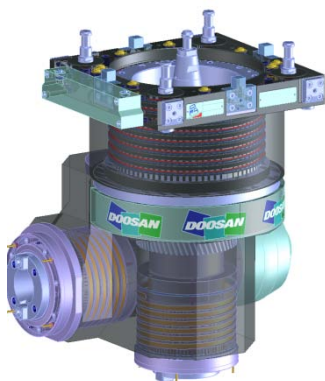
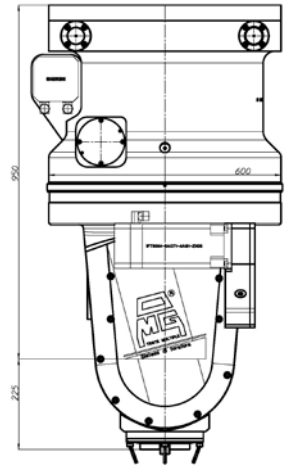

Twin Spindle Angle Head **HW501**

- Power up to 50 Kw
- Torque 650 Nm on horizontal spindle
- Booth spindle cooling
- Ratio I-O: 1-1
- Max RPM 3.000
- ATC output: BT50, DIN69871-A50, DIN69893-HSK100, CAPTO C8
- Coolant through the tool centre
- Weight Kg 500

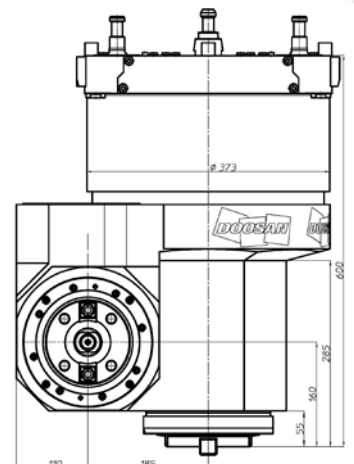



Made in Italy

Sistemi di foratura
Sistemi di foratura

Accessories for the **BigMachinesTools**



Extended Angle head **TAS23809**

- Power up to 40 Kw
- Torque 600 Nm
- Ratio I-O: 1-1
- Max RPM 2.000
- Output BT50, DIN69871-A50, DIN69893-HSK100. Manual tool change by pull stud
- Weight Kg 200

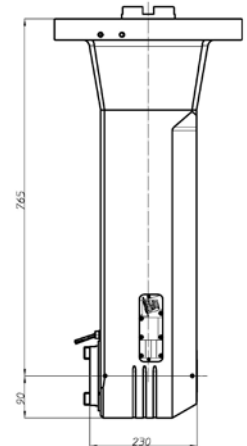

Extended Angle Head **TAS23408**

- Power up to 25 Kw
- Torque 300 Nm
- Ratio I-O: 1-1
- Max RPM 3.000
- Output BT40, DIN69871-A40, DIN2080-40, DIN69893-HSK63, CAPTO C6. Manual tool change by screw
- Weight Kg 65

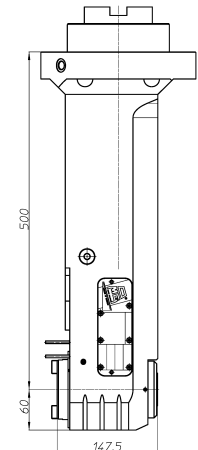

Extended Angle Head **TAS06708**

- Power up to 35 Kw
- Torque 500 Nm
- Ratio I-O: 1-1
- Max RPM 2.500
- Output BT50, DIN69871-A50, DIN2080-50, DIN69893-HSK100, CAPTO C8. Manual tool change by screw
- Weight Kg 125

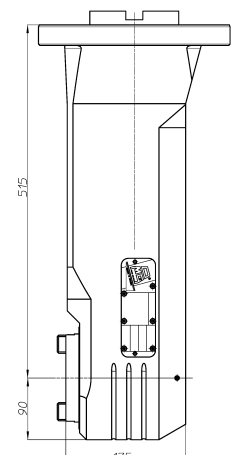

The **Big**Technology for the **Big**Industry

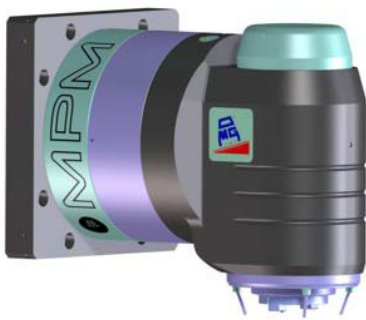

Angle head TAS07710

- Power up to 70 Kw
- Torque 1100 Nm
- Ratio I-O: 1-1
- Max RPM 5.000
- ATC output: BT50, DIN69871-A50, DIN69893-HSK100, CAPTO C8
- Automatic C axis rotation: step 1° or 2,5°
- Cooling on all axis
- Coolant through the tool centre
- Weight Kg 550

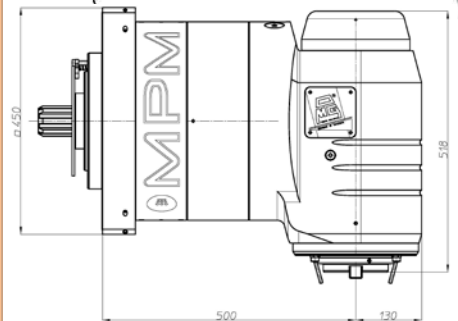

Reverse Angle Head TFS41304

- Power up to 50 Kw
- Torque 900 Nm
- Ratio I-O: 1-1
- Max RPM 2.000
- Output BT50, DIN69871-A50, DIN2080-50, DIN69893-HSK100, CAPTO C8. Manual tool change by screw
- Weight Kg 330

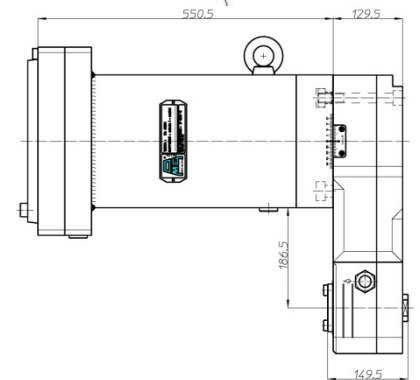

Angle Head TAS12609

- Power up to 50 Kw
- Torque 800 Nm
- Ratio I-O: 1-1
- Max RPM 4.500
- Output BT50, DIN69871-A50, DIN2080-50, DIN69893-HSK100, CAPTO C8. Manual tool change by screw
- Coolant through the tool centre and by nozzle
- Weight Kg 130

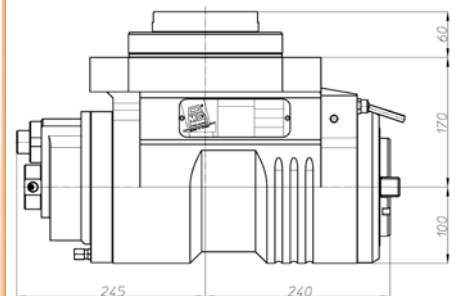



Headquarter

O.M.G. srl

Via 8 Marzo, n. 1 – 42025 CAVRIAGO (RE) – Italy

Tel. +39 0522 941627

Fax +39 0522941951

www.omgnet.it

e-mail: omg@omgnet.it



Overseas Branch

O.M.G. NORTH AMERICA

802 Clearwater Loop, Post Falls, Idaho 83854

Ph. 864-440-8519

Fax 208-773-3021

www.omgamerica.com

e-mail: info@omgamerica.com